

COMANCHE GEAR

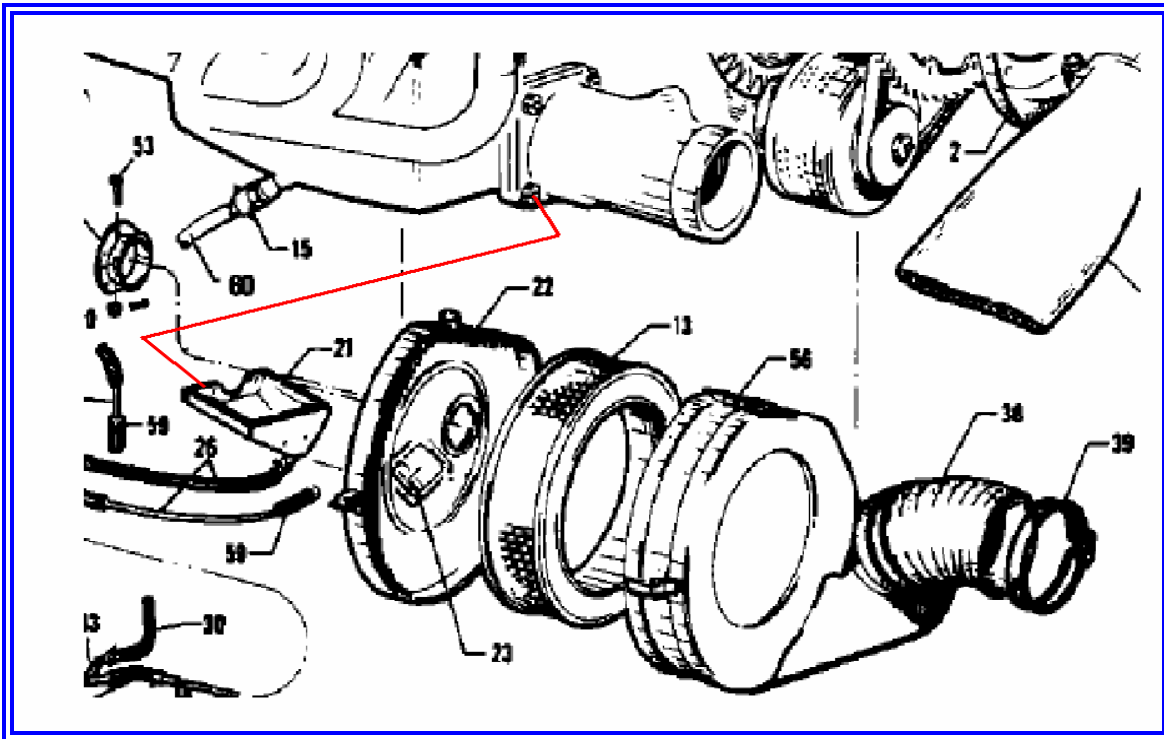

10340 REGENT CIRCLE ∞ NAPLES, FL 34109 ∞ MKURKE@COMANCHEGEAR.COM
PHONE & FAX 239/593-6944 ∞ CELL 239/404-7524



INSTALLATION

IT IS IMPORTANT TO WATCH A COUPLE DETAILS UPON INSTALLATION OF SOME COMPONENTS.

1) AT TWO LOCATIONS THERE SHOULD BE AN EXTRA-THICK 5/16" SPACER/WASHER BETWEEN THE #21 AIR FILTER BRACKET ASSEMBLY AND THE BENDIX FI ASSEMBLY **SEE THE RED LINE**. PLEASE PAY ATTENTION TO THIS AND THE INSTALLATION WILL BE LESS PRONE TO FUTURE CRACKING FOR THE #22 "AIR FILTER BOX PLATE ASSEMBLY" WHICH IS ONE OF THE PROBLEMS I JUST REPAIRED FOR YOU. I HAVE PROVIDED THIS PART FOR YOU ☺ .

2) THE 7 CAMLOC® LATCHES MUST BE SECURED TO AVOID AN INADVERTENT UNLATCHED CONDITION. THE FACTORY TABS DIDN'T DO THE JOB WHICH ALSO CONTRIBUTED TO THE FAILURE.

IF YOU CHOOSE TO RE-DO THE WEIGHT AND BALANCE; THE REPAIRED ASSEMBLY WEIGHS 4LBS 11OZ, A GAIN OF 1LB - 8OZ DUE TO THE REPAIR AND 3 ADDITIONAL CAMLOC® LATCHES.

MAINTENANCE FOR CONTINUED AIRWORTHINESS

CHECK THE CONDITION OF THE ANTI-CHAFF FIBERGLASS TAPE AROUND THE CIRCUMFERENCE OF THE BOX COVER AND ESPECIALLY CHECK THE SEALING SILICONE BETWEEN THE AIR BOX COMPONENTS; THIS IS CRITICAL TO THE CONTINUED GOOD PERFORMANCE OF THE AIR BOX ASSEMBLY. THE COMPRESSION OF THIS SILICONE MATERIAL IS IMPORTANT TO AVOID A LOOSE CONDITION. ALSO CHECK THE 7 CAMLOC® LATCHES FOR PROPER ADJUSTMENT; THEY MUST ALSO BE ADDITIONALLY SECURED. THIS LACK OF A GOOD METHOD TO SECURE THESE LATCHES WAS ANOTHER REASON THIS DESIGN FROM PIPER WAS A BIT WEAK COUPLED WITH NO CUSHIONING. I HAVE HAD SUCCESS WITH THE LOWLY TIE-RAP, BUT SAFETY WIRE SOUNDS A BIT MORE AVIATION-LIKE AND WOULD PROBABLY MAKE YOUR INSPECTOR A BIT HAPPIER TOO. SEE THE INFORMATION ON THE FOLLOWING PAGE COVERING THE MAINTENANCE MATERIALS WHICH SHOULD BE INCLUDED IN YOUR ANNUAL INSPECTION PROCEDURE.

COMANCHE GEAR



10340 REGENT CIRCLE ∞ NAPLES, FL 34109 ∞ MKURKE@COMANCHEGEAR.COM
PHONE & FAX 239/593-6944 ∞ CELL 239/404-7524

FOR THE FOLLOWING MAINTENANCE MATERIALS, GO TO:
[HTTP://WWW.MCMASTER.COM](http://www.mcmaster.com)

THE MATERIALS REFERENCED HERE ARE SUBJECT TO PRICE CHANGE; I HAVE INCLUDED THE INFORMATION TO ASSIST YOU WITH LOCATING THESE MAINTENANCE ITEMS.

Fiberglass Cloth Tape



With the ability to absorb insulating varnish, this durable, woven fiberglass tape (also known as glass cloth tape) is an excellent choice for electrical insulating. Tape has a silicone adhesive coupled with high tensile strength for excellent temperature and abrasion resistance. It's also conformable and flexible. Use as an overwrap on motor rewinds, a protective wrap for wire and cables, and as a high-temperature masking tape for welding stainless steel.

Total tape thickness is .007" and consists of a .0045" fiberglass cloth with .0025" of silicone adhesive. Color is white. Dielectric strength (the ability to withstand electrical voltage without rupture) is 4000 volts and tensile strength is 150 lbs./in. width. Temperature range is -100° to +500° F. Tape is supplied on a cardboard spool with a 3" ID.

Width	Length, yds.	Per Roll
1/2"	18	7574A11 \$6.90
1"	18	7574A12 13.83
2"	18	7574A13 27.67

3202

MCMASTER-CARR

P/N 7574A11 @ \$6.90/ROLL IS THE MATERIAL USED AROUND THE BOX CIRCUMFERENCE TO HELP AVOID THE CHAFFING PROBLEM.

ADHESIVE-BACK STRIPS

Thick.	Thick. Tolerance	Length	1/4" Wide		3/8" Wide	
			Each		Each	
Smooth Finish— With Skin						
1/16"	±0.024"	15 ft.	5109K11	\$7.90	5109K12	\$8.23
3/32"	±0.024"	15 ft.	5109K21	9.35	5109K22	11.18
1/8"	±0.032"	15 ft.	5109K31	10.52	5109K32	12.77
3/16"	±0.032"	15 ft.	5109K41	12.23	5109K42	16.75
1/4"	±0.035"	3 ft.	5109K51	3.66	5109K52	5.02
Criss-Cross Textured Finish— With Skin						
1/16"	±0.016"	30 ft.	8645K15 †	13.67	8645K16 †	16.46
3/32"	±0.016"	30 ft.	8645K25 †	20.57	8645K26 †	25.23
1/8"	±0.032"	30 ft.	8645K35 †	23.15	8645K36 †	24.90
3/16"	±0.032"	15 ft.	8645K45 †	15.44	8645K46 †	20.60
1/4"	±0.047"	3 ft.	8645K55 †	4.52	8645K56 †	5.30

† Adhesive is silicone and has a temperature range of -100° to +450° F.

MCMASTER-CARR

3343

P/N 8645K16 @ \$16.46/ROLL IS THE MATERIAL USED INSIDE THE BASE TO CUSHION AND HELP SEAL THE COVER TO BASE ASSEMBLY CONTACT AREA.