

COMANCHE GEAR



10340 REGENT CIRCLE ∞ NAPLES, FL 34109
PHONE & FAX 239/593-6944 ∞ CELL 239/404-7524
MKURKE@COMANCHEGEAR.COM

STALL WARNING CIRCUIT BOARD AND FLASHER

IF YOUR STALL WARNING DOES NOT "FLASH", THE FLASHER UNIT MAY BE INOPERATIVE OR A PROBLEM WITH THE CIRCUIT BOARD.

SEND THE "TUNG-SOL" FLASHER WITH THE CIRCUIT BOARD [SINGLES] TO ME; I WILL REFURBISH AND TEST THE STALL CIRCUIT BOARD AND FLASHER.

THAT INCLUDES DISASSEMBLE, CLEAN IN ULTRASONIC BATH, NEW PROPERLY-MARKED WIRES, REASSEMBLE, AND TEST. DOING THIS WILL AT LEAST ELIMINATE THAT PORTION FROM THE TROUBLESHOOTING AND ASSURE YOURS IS OPERATIVE; YT INCLUDED. ONE-DAY TURN-AROUND; \$60.

THE "TUNG-SOL" FLASHERS ARE VERY EXPENSIVE NEW AND DIFFICULT TO FIND. A LATER PIPER FLASHER IS AVAILABLE BUT NOT APPROVED.

I CAN EVEN PROVIDE AN MPEG ON A DISC OF THE "TEST" OPERATION BUT YOU NEED TO REQUEST THAT OR I MAY FORGET.

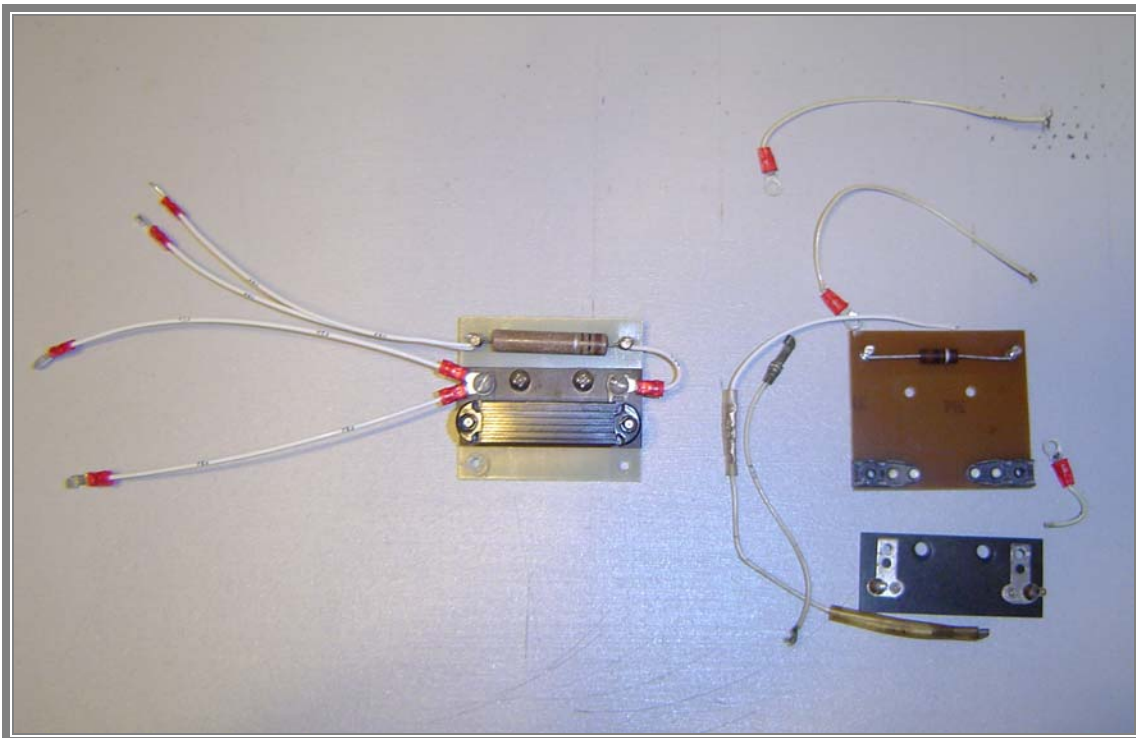

STALL WARNING CIRCUIT BOARD, BEFORE AND AFTER.

COMANCHE GEAR



10340 REGENT CIRCLE ∞ NAPLES, FL 34109
PHONE & FAX 239/593-6944 ∞ CELL 239/404-7524
MKURKE@COMANCHEGEAR.COM

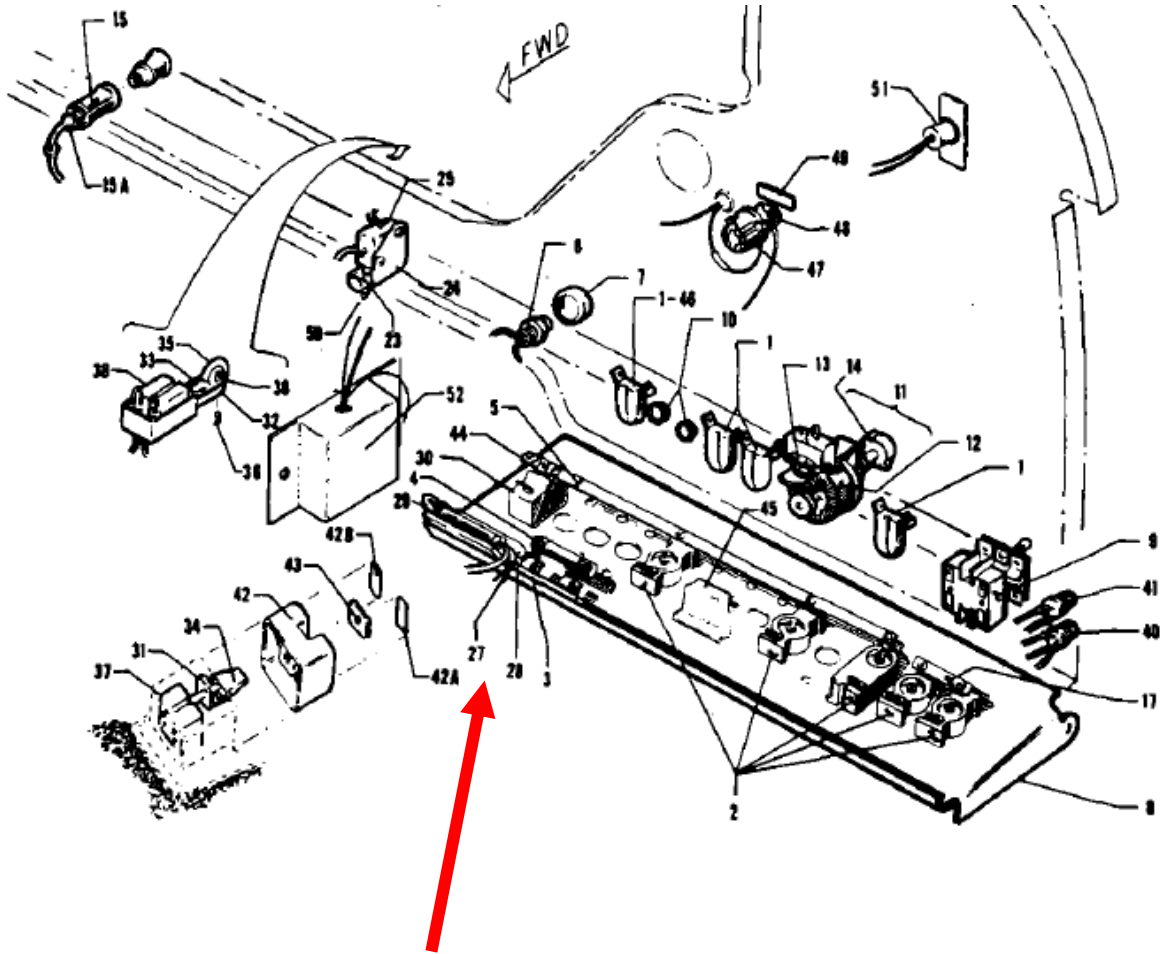

THE STALL CIRCUIT BOARD #28 IS MOUNTED ONTO THE CIRCUIT BREAKER PANEL. THIS ILLUSTRATION APPLIES TO THE 250s, 260s [EXCEPT C MODEL], AND 400s.